



FLO Home™ G5 Model

Installation Manual



Table of Contents

Specifications	3
Safety Instructions	4
Planning your Installation	5
Box Contents	6
Installing the Station	7
Light Indicator	10
Compliance	11
Limited Warranty	12



MODEL NUMBER: FH-1-STA-G5-HY5G-FL1

MANUFACTURER: AddÉnergie Technologies Inc.

Specifications

Reliable: Extremely robust, your new residential charging station is valued for its high reliability and construction quality. It is designed to withstand extreme temperatures with its commercial-grade cable, which is always flexible, even in extreme cold conditions.

Security: Your station is equipped with mechanisms that protect you and your vehicle against fluctuations in the electrical network.

Robust: With its housing made of 100% aluminum and its high performance connector, your station is designed of materials of the highest quality to last, again and again!

Made in Canada: Designed and manufactured in Canada by AddEnergie, the #1 supplier of charging solutions in the country.

Casing: 100% aluminum NEMA 4X certified designed for outdoor or indoor installation

Finish: Anthracite grey with high resistance coating

Voltage: 208 - 240 V @ 60 Hz

Output Current: 30 A

Maximum Output Power: 7.2 kW @ 240 V or 6.2 kW @ 208 V

Cable: 7.62 m (25 ft) ultra flexible cable

Charging Connector: SAE J1772™ designed to withstand over 10,000 charging cycles

Security Features: Integrated GFCI circuit breaker (20 mA, 3 reset attempts at 15-minute intervals)

Operating Temperature: -40°C to 50°C (-40°F to 122°F)

Weight with cable, connector and mounting plate: 11.23 kg (24.76 lbs)

Communication Interface: None

Safety Instructions

INSTRUCTIONS PERTAINING TO A RISK OF FIRE OR ELECTRIC SHOCK SAVE THESE INSTRUCTIONS

WARNING: When using electrical appliances, basic precautions should always be followed. This manual contains important instructions that must be followed when installing, operating and maintaining the unit. **Please read this guide carefully before attempting to install the charging station.**

1. **CAUTION** -To reduce the risk of fire, connect only to a branch circuit provided with a maximum surge protection of 40A in accordance with the Canadian Electrical Code (CSA C22.1-12) and the National Electrical Code (ANSI / NFPA 70).
2. This charging station has been designed for wall or post mounting.
3. Ensure that the mounting surface for the wall or pole are strong enough to support the weight of the charging station and that the anchors used are compatible with the surface.
4. Verify that there is no piping, electrical installation or underground electrical installation in the area where you will install the station, to avoid serious injuries.
5. Connect the power supply of the charging station with caliber 6 AWG to 8 AWG copper conductors rated for usage at a temperature of at least 75°C.
6. This product must be connected to a grounded, metal, permanent wiring system, or an equipment-grounding conductor must be run with the circuit conductors and connected to the equipment grounding terminal and installed by a certified electrician.
7. Communicate with a certified contractor, certified electrician or trained installer to ensure compliance with local building code, regulation, security standards and weather conditions.
8. Any modification to a part of the charging station will void the warranty.
9. Handle parts with care, since they can be sharp-edged. Always use safety glasses and gloves when unpacking and installing.
10. Do not install on or over a combustible surface.
11. The power supply cables of the charging station must be rated FT2 minimum.
12. The input cable strain relief, conduits or armed-cable bushings and adapter:
 - A) have to be certified for both Canada and USA;
 - B) have to be waterproof (NEMA 4X);
 - C) have to be suitable for the outside diameter of the chosen cable and suitable for mounting into a 28.17 mm (1,109 in) diameter opening (for connection through the bottom or back cable opening).

GENERAL SAFETY INSTRUCTIONS

This device should be supervised when used around children.

Never insert your finger into the electric vehicle connection.

Never use the charging station if the flexible power cord or EV cable is frayed, has broken insulation, or any other signs of damage.

Never use the charging station if the enclosure or the EV connector is broken, cracked, open, or shows any other signs of damage.

This charging station was designed to be used with electric vehicles equipped with a SAE-J1772 connector.

This charging station is to be used to charge vehicles that do not require a ventilated environment during charging.

Always disconnect the power supply of the charging station before servicing.

Do not put fingers into the electric vehicle connector.

Planning your Installation

IMPORTANT CONSIDERATIONS WHEN INSTALLING THE STATION

The station must be installed by a certified electrician.

The station has built-in protection against overvoltage conditions and leakage current to ground.

Any alteration to any part of the charging station will void the warranty.

Connecting your new charging station requires:

- Single-Phase 120/240 VAC supply (figure 1) or 3-Phase 120/208 VAC supply (figure 2)
- A connection with 6 AWG to 8 AWG copper conductors
- Protection by a 40A double circuit breaker or two fuses
- 2 phases and a ground connection with 120 VAC between each phase and ground

Note: Neutral is not required.

Maximum output power: 7.2 kW @ 240 V or 6.2 kW @ 208 V

Figure 1

Single-Phase 120/240 VAC

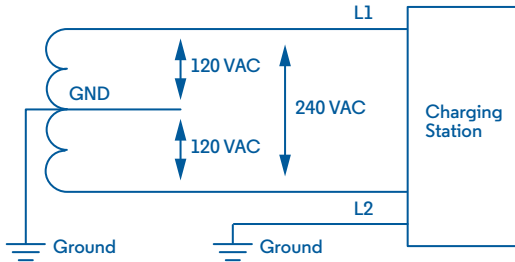
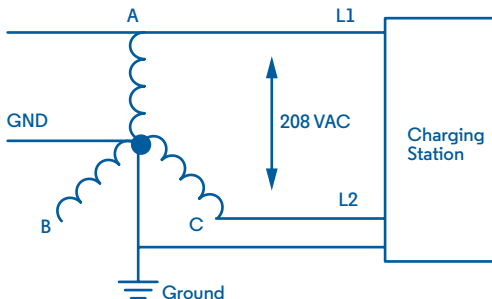

Figure 2

3-Phase 120/208 VAC



Box Contents

1. Charging Station
2. Cable and charging connector
3. Wall mounting plate

Recommended height to facilitate handling of the connector, as well as preventing the cable from touching the ground.

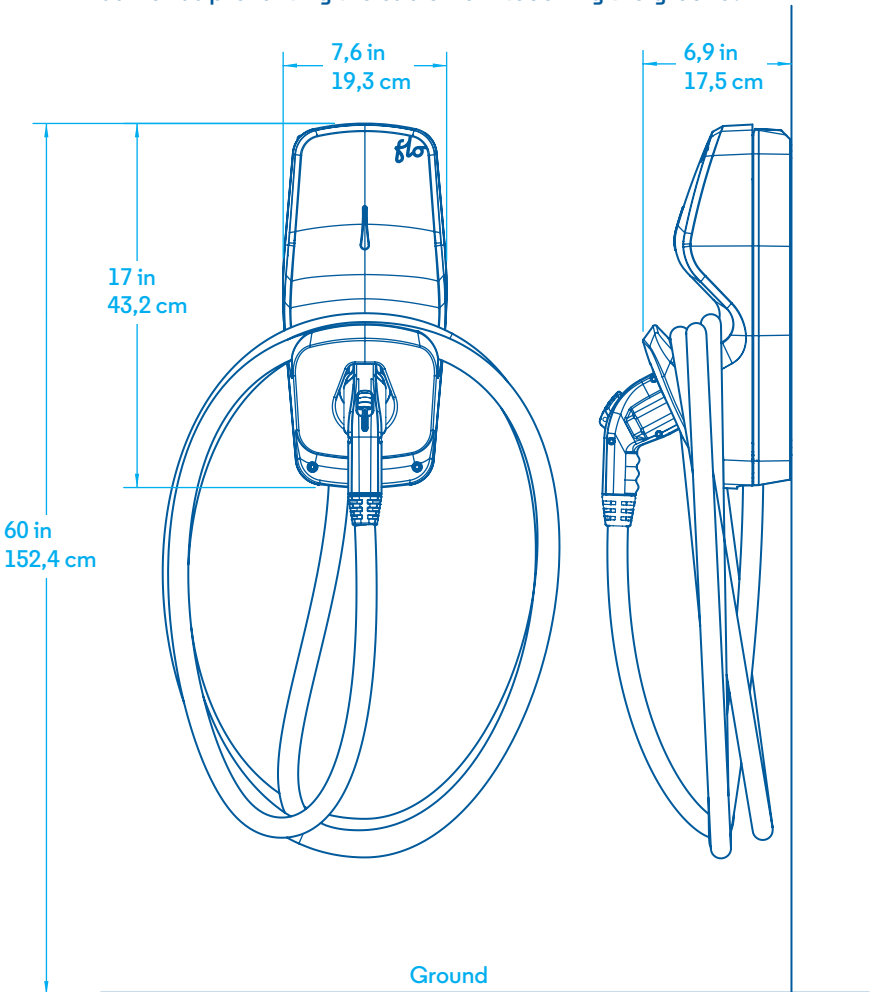

Installing the Station

WARNING Your station must be installed by a certified electrician.

- 1 Disassemble the front housing by removing the 2 front screws and then separate the mounting plate by unscrewing the lower screw.

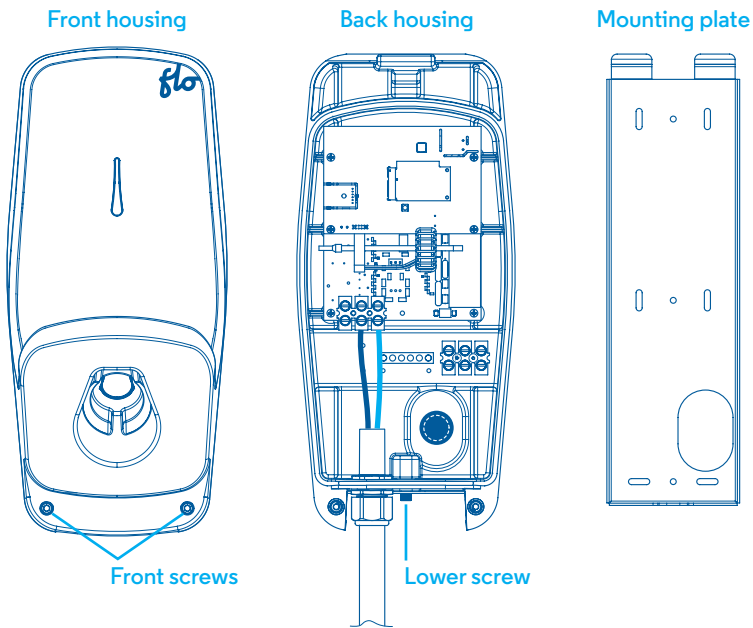

NOTE

The power supply cable can be inserted from the rear (a) or from under (b) the station:

- 3/4 knockout (a) and (b)
- Remove a single cap
- Strain relief not included

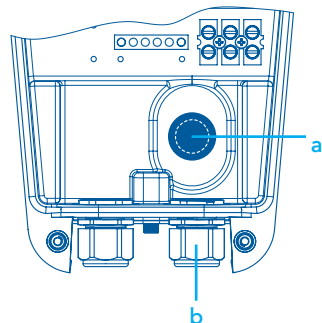

Installing the Station

- 2 Use the mounting plate as a drilling template after determining the input to be used, either at the rear or under the station.
- 3 Hang the mounting plate securely to a stable surface using a minimum of 3 anchor screws.

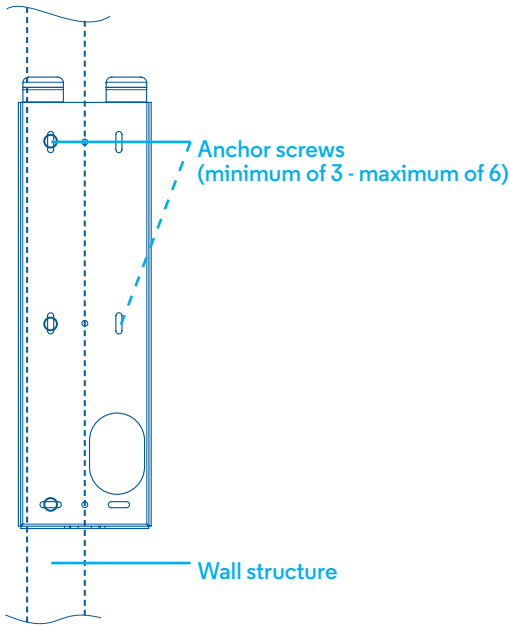

- 4 Insert the conductors and secure the strain relief to the rear housing so that the conductors are long enough to reach the terminals.
- 5 Secure the rear housing of the station to the mounting plate.
- 6 Screw the lower screw to secure the mounting.

7 Connect the two power wires (L1 and L2) and the ground wire (GND).

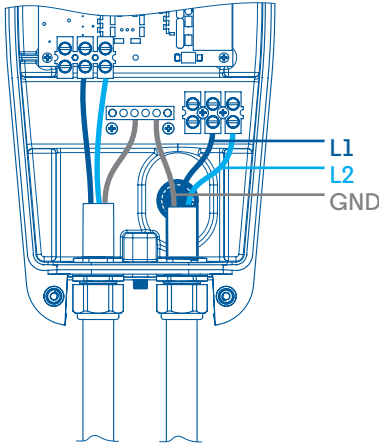

Nominal torque for conductors:

L1-L2: 6 AWG = 16 lbs-in

8 AWG = 16 lbs-in

GND: 6 AWG = 45 lbs-in

8 AWG = 40 lbs-in

WARNING: Always use a manual screwdriver; DO NOT use a Impact Driver for the station screws, in which case the warranty would no longer be valid.

8 Install the front housing of the charging station:

- Hang the top by presenting the front housing at an angle of about 30 degrees, then pivot vertically without forcing.
- Tighten the 2 front screws with a nominal torque of 55 lbs-in.

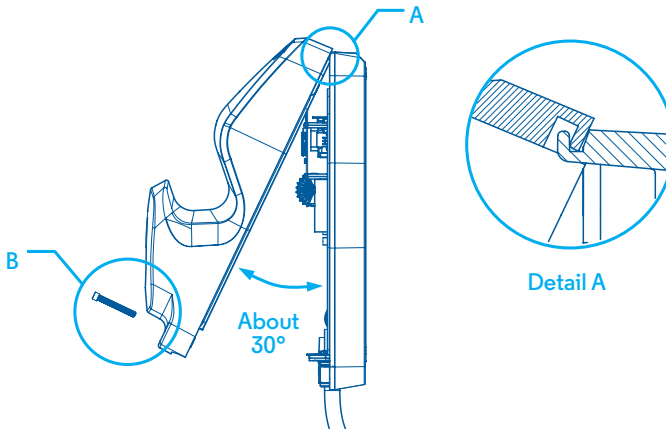

9 Switch on the electrical circuit breaker. *Your new station can now charge your vehicle!*

Light Indicator

A) Station Status

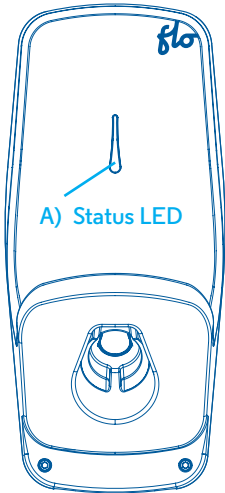

Stable: Powered station, ready for use



Stable: Connector connected to the vehicle, without energy transfer



Stable: Connector plugged in, with energy transfer



Blinking: Fault requiring an action

- 1 time No ground connection (switch off the station and check electrical installation)
- 2 times Ground Fault, the charging station will attempt to automatically restart the charging session after 15 minutes
- 3 times Ventilation Required for Vehicle (please contact our technical support)
- 4 times Communication error with the vehicle (please contact our technical support)
- 5 times Internal error (switch off the station and then restart it and if the problem persists, contact our technical support)
- 6 times Maximum ground fault during a load session (switch off the station and then restart it and if the problem persists, contact our technical support)
- 7+ times Internal error (switch off the station and then restart it and if the problem persists, contact our technical support)

Compliance



IC statement: CAN ICES-3 (B)/NMB-3 (B)

This device complies with Industry Canada licence-exempt RSS standard(s) Operation is subject to the following two conditions: (1) this device may not cause interference, and (2) this device must accept any interference, including interference that may cause undesired operation of the device.

FCC statement (for USA only)

This device complies with Part 15 of the FCC Rules. Operation is subject to the following two conditions: (1) This device may not cause harmful interference, and (2) this device must accept any interference received, including interference that may cause undesired operation. This equipment has been tested and found to comply with the limits for a Class B digital device. These limits are designed to provide reasonable protection against harmful interference in a residential installation. This equipment generates, uses and can radiate radio frequency energy and, if not installed and used in accordance with the instructions, may cause harmful interference to radio communications. However, there is no guarantee that interference will not occur in a particular installation. If this equipment does cause harmful interference to radio or television reception, which can be determined by turning the equipment off and on, the user is encouraged to try to correct the interference by one or more of the following measures: Reorient or relocate the receiving antenna; Increase the separation between the equipment and receiver; Connect the equipment into an outlet on a circuit different from that to which the receiver is connected; Consult the dealer or an experienced radio/television technician for help.

Compliance with safety standards

- CSA C22.2 No. 0-10 General Requirements – Canadian Electrical code, part II.
- CSA C22.2 No. 281.1-12/UL2231-1 Standard for safety for personnel protection systems for electrical vehicle (EV) supply circuits: General requirements.
- CSA C22.2 No. 281.2-12/UL2231-2 Standard for safety for personnel protection systems for electric vehicle (EV) supply circuits: Particular requirements for protection devices for use in charging systems.
- CSA C22.2 No. 280-13/UL2594 (1st edition) Electric vehicle supply equipment (EVSE).
- CSA C22.2 No. 0.8-12 Safety functions incorporating electronic technology.
- UL1998 Standard for software in programmable components.
- UL991 Standard for Tests for Safety-Related Controls Employing Solid-State Devices.
- NEC 2014 section 625.

3 Year Limited Warranty

COVERAGE

This warranty covers the product “FLO Home™ G5 Model” purchased and used in Canada. FLO warrants the purchaser that its product is free from defects in materials and workmanship. This warranty is valid for a period of three (3) years from the date of purchase of the product sold by FLO, its subsidiaries or authorized dealers. This warranty applies only to the end user who holds the original purchase invoice.

SCOPE

This warranty does not apply to any defect resulting from improper use or improper installation, to any product that has been altered or repaired by any party other than a service repair authorized by FLO, to damages attributable to an accident, including, but not limited to, fire, lightning, flood, earthquake, or when the serial number has been removed or degraded.

LIMITED REMEDIES

In the event of breach of this warranty, FLO’s obligations and exclusive remedy for the buyer are limited, at FLO’s sole discretion, to repairing the product found to be in breach of warranty within a reasonable period of time or to replace the product by an equivalent product provided that the equipment is returned to the point of sale or at any other place indicated by FLO, together with the original purchase invoice. FLO may use new or refurbished and functionally equivalent parts or products. Any repaired or replaced product is only warranted for the remaining period of the original warranty. In no event shall FLO’s liability exceed the purchase price paid by the buyer. FLO expressly disclaims all other warranties, express or implied. FLO shall not be liable for any damages or losses resulting from the failure of the product or from personal injury or property damage arising from the installation or handling of the product.

CLAIM PROCEDURE

For any complaints, please contact FLO technical support.

This warranty gives you specific legal rights. You may also have other rights that vary from jurisdiction to jurisdiction. Please contact your retailer or our customer service center for details on our limited warranty, including those not covered by this limited warranty.

For more information online, visit: <https://flo.ca>

Assistance

FLO offers 24/7 assistance

You have questions about the installation of your station at home or need assistance?

A technical support representative can assist you 24 hours a day, 7 days a week.

1-844-825-3356

flo.ca