



## SmartTWO

### Smart level 2 charging station for public and commercial applications

The SmartTWO charging station is designed for public locations subject to harsh weather and vandalism.

#### Benefits

- Unique locking mechanism to protect the connector (U.S. Pat. No. 9,421,878B2); door unlocks on authentication
- Rugged and reliable design able to withstand harsh weather

#### Smart Charging Solution

- **Enhanced charging station owner experience** – Complete remote management capabilities including software and firmware updates
- **Enhanced user experience** – Deliver real-time updates and notifications to drivers
- **Revenue generation** – Implement payment services to generate revenue
- **Access control** – Configure stations to authorize access using the FLO mobile app or RFID card authentication

#### Key features

- NEMA 3R aluminum casing
- Certified to operate in temperatures ranging from -40 °C to 50 °C / -40 °F to 122 °F
- Equipped with a charging cable that remains flexible at low temperatures
- Wall-mounted, pedestal or pole-mounted configuration
- Modular design to facilitate the installation of additional units and maintenance
- Access provided free of charge or according to a usage fee
- LED status indicator

## Overview

---

The SmartTWO charging stations are designed for outdoor / indoor vandal-prone public areas, or any place where robustness, durability and access control systems are critical. The SmartTWO is a user-friendly connected charging station that allows comprehensive and easy access to data via centralized information management software and can also generate revenue through usage fees.

### Patented locking mechanism for maximum protection

The SmartTWO comes with a patented door locking mechanism. This means the mechanism unlocks only when a user authenticates, otherwise the door will remain closed. The connector will remain safe from vandals and will not be damaged from bad weather.

### Physical features

- Rugged charging station able to withstand extreme weather and corrosion
- Thick and sturdy casing
- Universal SAE J1772 connector
- Flexible 25-foot cable that remains malleable even during winter's coldest temperatures

## Applications

---

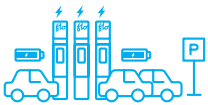

### Commercial parking lots

- For business owners wanting to provide their customers with charging stations
- For businesses wanting to offer first class customer experience and become a destination of choice.



### Workplace

- For business owners who want to demonstrate their sustainable development leadership

For employers that want to provide their employees with a monitored charging service in a vandal-prone area

## Available configurations



Wall-mounted

Double wall-mounted

Single pedestal

Double pedestal

Quadruple pedestal

Single pole-mounted

Double pole-mounted

## Dimensions and customization

1

Every charging station includes easily customizable branding areas. The SmartTWO comes in its original colour, which can be modified with your custom signage.

**Customizable partner panel area:**

Dimensions (H x W):  
500 mm (19.7") x 152.4 mm (6")

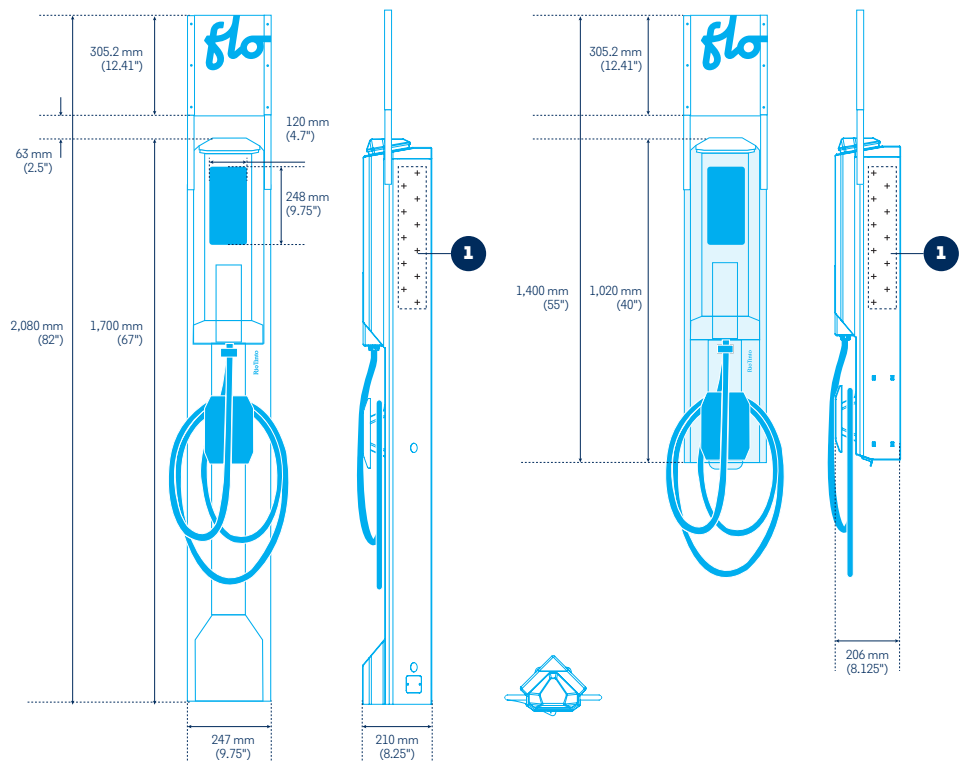

# Technical specifications

<b>Aluminum casing</b>	NEMA 3R
<b>Charging connector</b>	SAE J1772
<b>Cable</b>	7.62 m / 25' Ultra Flex
<b>Electrical load</b>	30 A @ 208 VAC or 240 VAC
<b>Charging power</b>	1.2 kW to 7.2 kW (Maximum configurable by software)
<b>Output current</b>	6 A to 30 A (Maximum configurable by software)
<b>Integrated GFCI</b>	20 mA, auto reset (3 attempts at 15-minute intervals)
<b>Frequency</b>	60 Hz
<b>Operating and storage temperature</b>	-40 °C to 50 °C / -40 °F to 122 °F
<b>Weight</b>	<b>Wall-mounted configuration:</b> 20 kg / 45 lb <b>Pedestal configuration:</b> 30 kg / 67 lb <b>Pole-mounted configuration:</b> 27 kg / 59 lb
<b>Humidity</b>	Up to 95% (non-condensing)
<b>Card reader</b>	ISO 14443 A/B, ISO 15693, NFC
<b>Communication interface</b>	ZigBee - IEEE 802.15.4 meshed network
<b>Networking</b>	Cellular – 3G (gateway is installed separately for optimal performances)
<b>Certifications</b>	CSA certified for Canada and United States Complies with UL 2594, UL 2231-1, UL 2231-2
<b>EMC Compliance</b>	USA - FCC 47 CFR 15, class A CAN - ICES-3 (A) / NMB-3 (A)



Learn more  
[info@flo.ca](mailto:info@flo.ca)  
 1 855 543-8356  
[flo.ca/products](http://flo.ca/products)



Designed and manufactured  
 by AddÉnergie